

Section A-A ( Scale 1 : 1 )

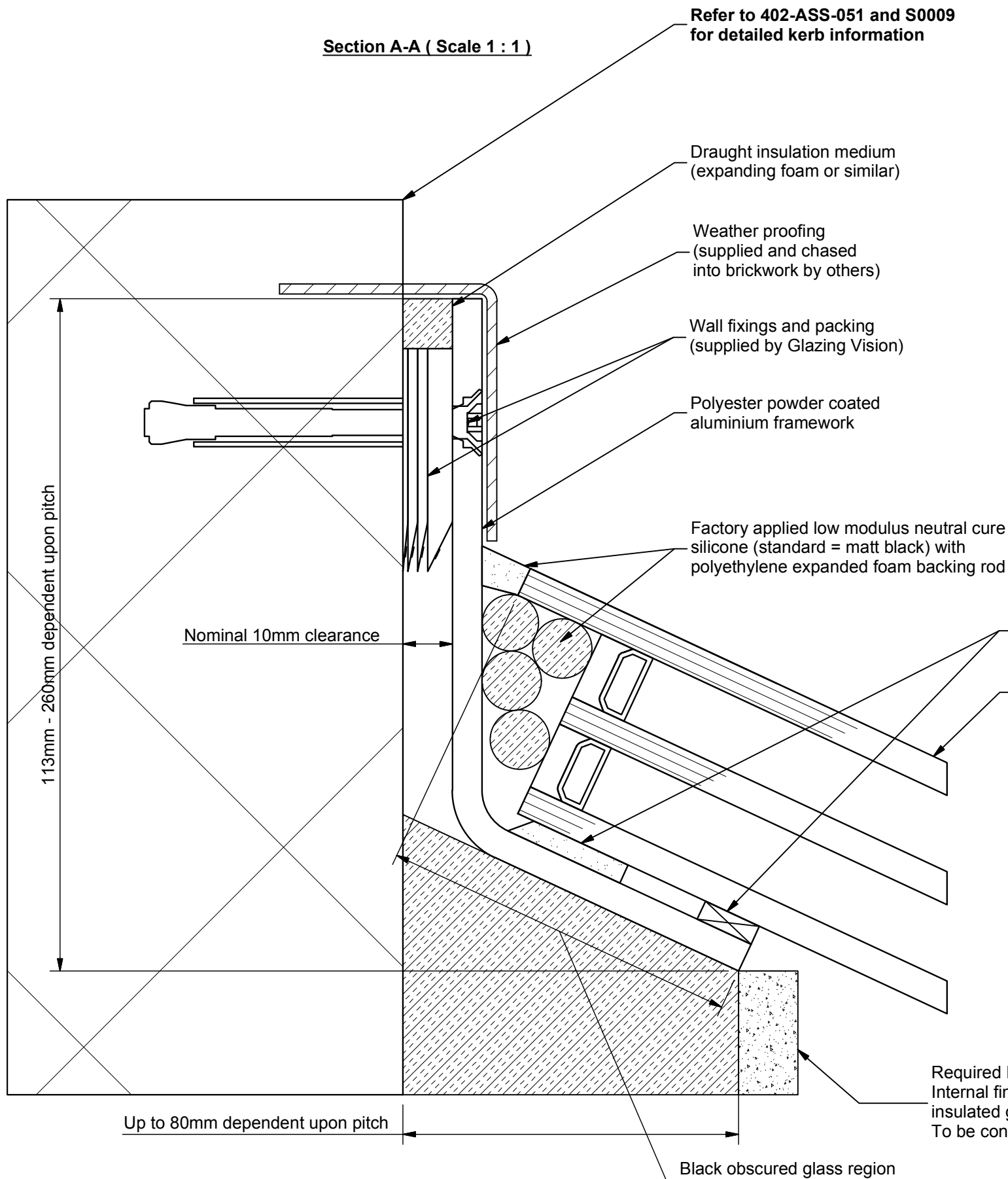

Plan view (NTS)

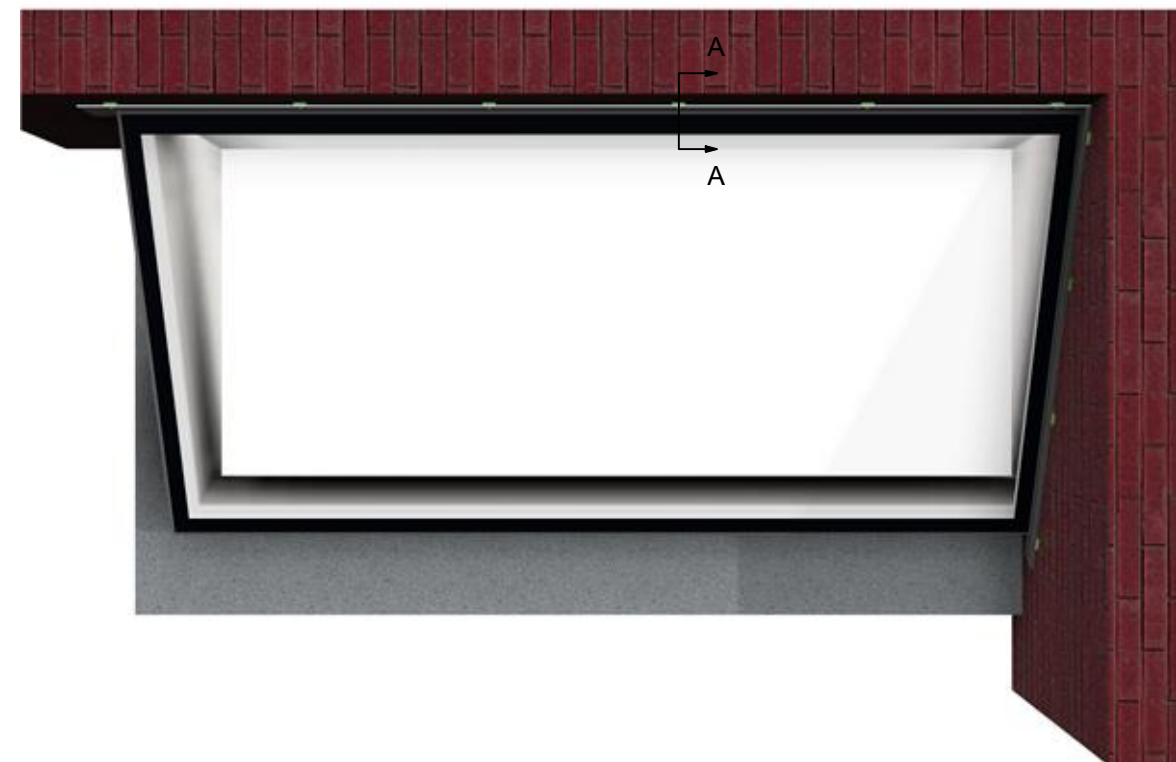

Wall abutment inset detail (NTS)

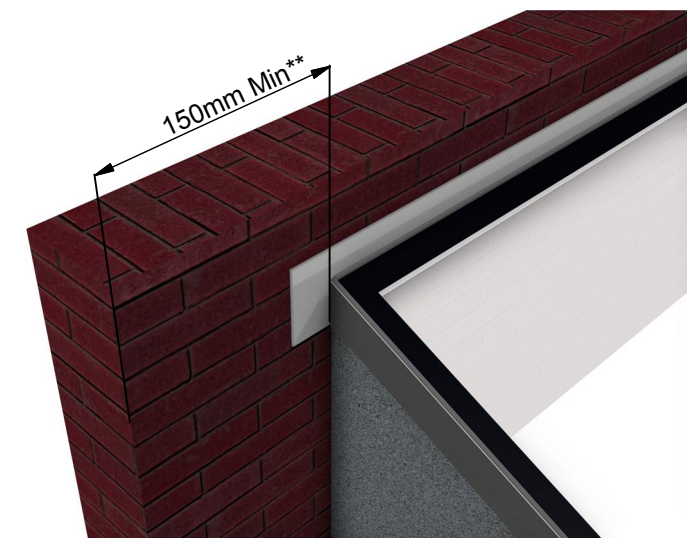

NOTE: Weathering flashing (by others) not shown on 3D views for clarity of Glazing Vision detail.

\*Specification dependent on client options and glazing area

\*\* Wall **must** extend a minimum of 150mm beyond outside face of kerb to ensure correct weathering (see top detail).

These views are of a 2 wall abutted Flushglaze, many other configuration options are available. **Please contact Glazing Vision to discuss your requirements.**

Rev	Revision Description	Drawn/Date
B	Description updated to suit 2017 MPFG	JSL 19.12.17
A	'Internal finishes' note amended	SW 03.08.16

<b>Product:</b> 402 - GV Standard Flushglaze		<b>Checked By:</b> HL
<b>Description:</b> Wall abutment detail (TGU) for folded-sheet wall-abutments		
<b>Materials:</b> As above		<b>Check Date:</b> 19.12.17
<b>Finish:</b> Std=RAL 7015	<b>Drawn By:</b> DylanR	
<b>Weight:</b> N/A	<b>Drawn Date:</b> 30.06.14	
<b>Quantity:</b> N/A	<b>Drawing No:</b> 402-ASS-059	
<b>Scale:</b> See above		