

Section A-A (Scale 1 : 1)

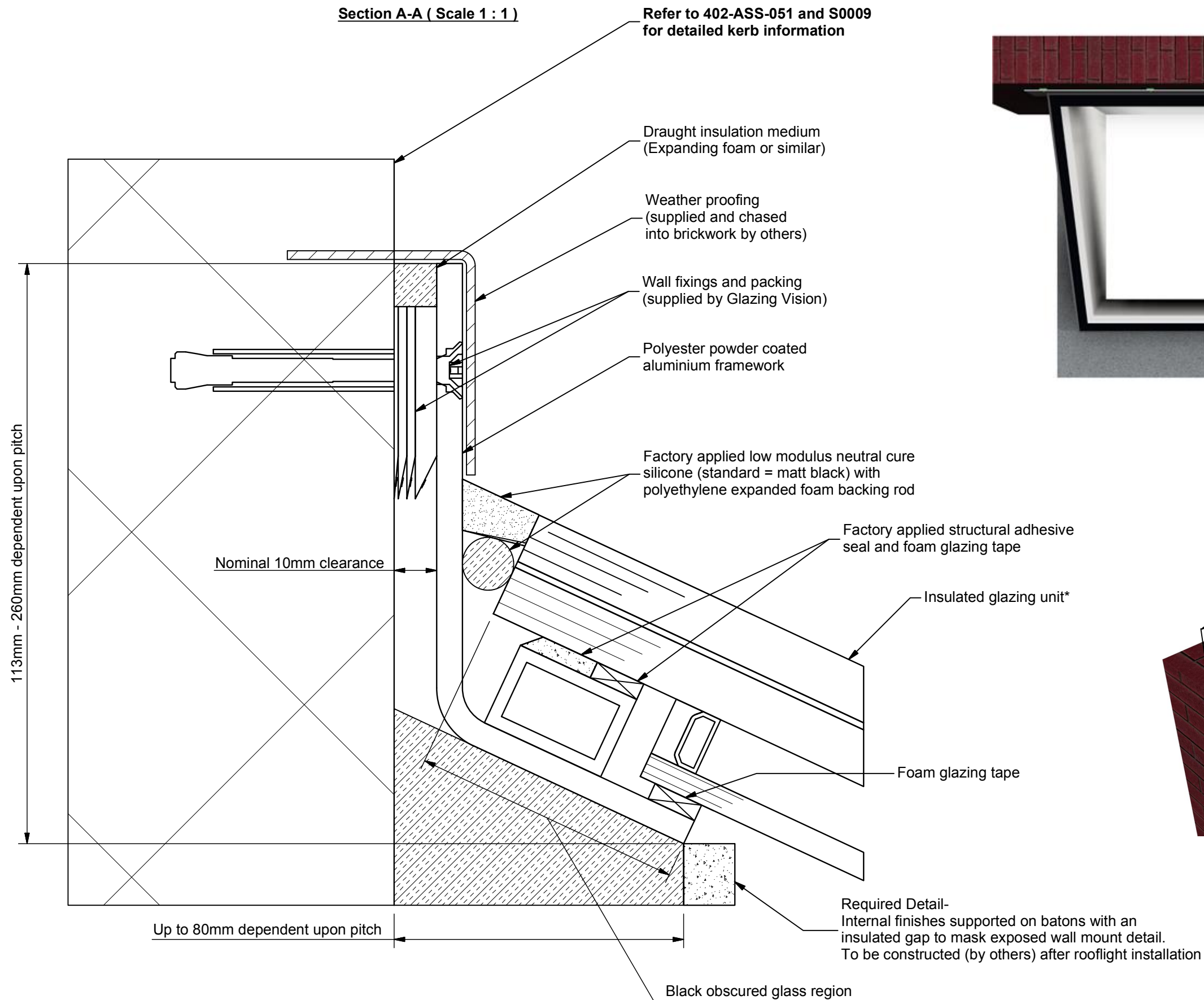

Plan view (NTS)



Wall abutment inset detail (NTS)

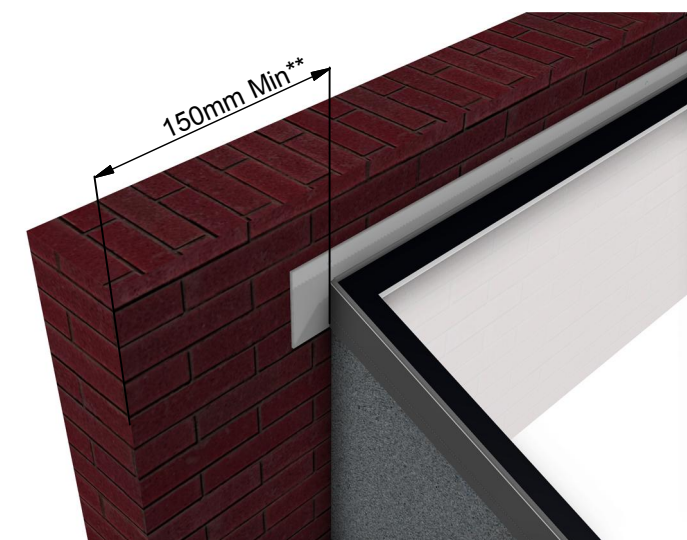

NOTE: Weathering flashing (by others) not shown on 3D views for clarity of Glazing Vision detail.

*Specification dependent on client options and glazing area

** Wall **must** extend a minimum of 150mm beyond outside face of kerb to ensure correct weathering (see top detail).

These views are of a 2 wall abutted Flushglaze, many other configuration options are available. **Please contact Glazing Vision to discuss your requirements.**

Rev	Revision Description	Drawn/Date
B	Description updated to suit 2017 MPFG	JSL 19.12.17
A	'Internal Finishes' note amended	Sw 03.08.16

Product: 402 - GV Standard Flushglaze		Checked By: HL
Description: Wall abutment detail (Walk-on) for folded-sheet wall-abutments		
Materials: As above		Check Date: 19.12.17
Finish: Std=RAL 7015	Drawn By: DylanR	
Weight: N/A	Drawn Date: 30.06.14	
Quantity: N/A	Drawing No: 402-ASS-060	
Scale: See above		