

Section C-C (Scale 1 : 2)

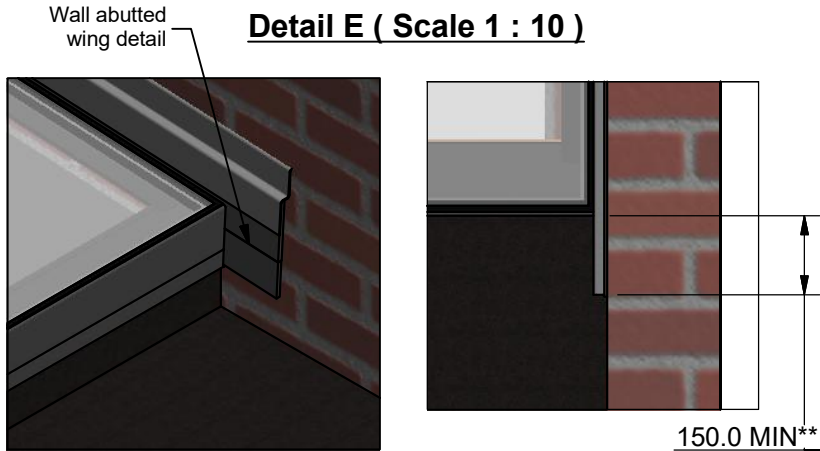
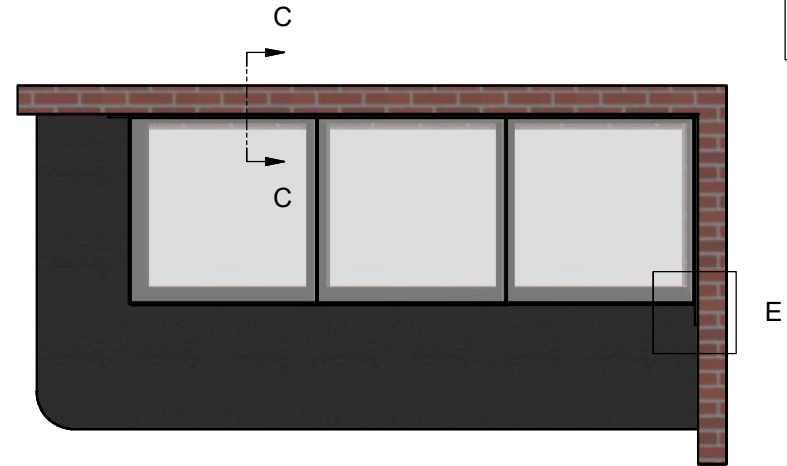
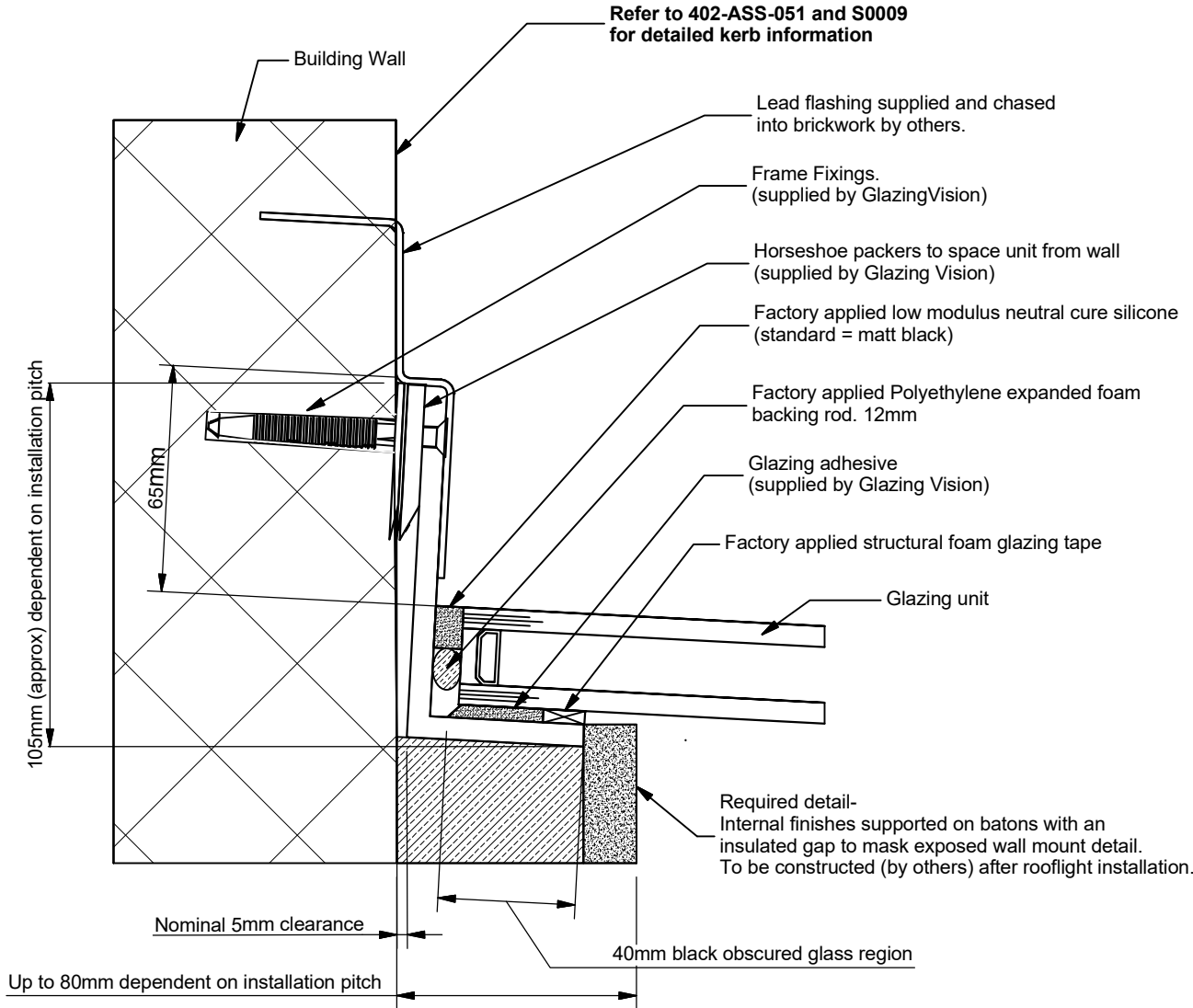

NOTE: Weathering flashing (by others)

** Wall **must** extend a minimum of 150mm beyond outside face of kerb to ensure correct weathering. (see detail above)

If you do not have space for our wing detail (as stated above) your rooflight will be non-standard. Please see sales drawing 402-BSK-010 for details.

<p>GLAZING VISION</p> <p>Saw Mills Road Diss Norfolk IP22 4RG</p> <p>Tel: +44 (0)333 8000 881 Fax: +44 (0)333 8000 882 Email: sales@glazingvision.co.uk Website: www.glazingvision.co.uk</p>	<p>IT IS GLAZING VISION'S POLICY TO CONTINUOUSLY DEVELOP AND IMPROVE OUR PRODUCTS. WE THEREFORE RESERVE THE RIGHT TO MODIFY OR CHANGE THE DETAIL DESIGN AT OUR DISCRETION AND WITHOUT PRIOR NOTICE. THIS DRAWING IS COPYRIGHT AND THE SOLE PROPERTY OF GLAZING VISION LTD. THE DESIGNS/INFORMATION IT CONTAINS ARE PRIVATE AND CONFIDENTIAL. IT MUST NOT BE COPIED, EXHIBITED OR COMMUNICATED TO THIRD PARTIES FOR ANY PURPOSE OTHER THAN THAT FOR WHICH IT WAS ISSUED WITHOUT THE WRITTEN PERMISSION OF GLAZING VISION LTD.</p>	<p>Third angle projection unless otherwise noted. Tolerances: Whole numbers = ±1mm One decimal place = ±0.5mm Two decimal places = ±0.2mm All angles 90±0.5 degrees unless specified IF IN DOUBT - ASK! DO NOT SCALE Supplier to deburr & remove sharp corners</p>	<p>Rev</p> <p>Description</p> <p>Drawn/Date</p>	<p>Product: 402 - GV Standard Flushglaze Description: Flushglaze wall mount detail (pitches upto and including 5 degrees)</p>	<p>Checked By: HL</p>
			<p>L</p> <p>Description amended</p> <p>SW 29.10.18</p>	<p>Materials: See above</p>	<p>Check Date: 29.10.18</p>
			<p>K</p> <p>'Internal Finishes' note amended</p> <p>SW 29.10.18</p>	<p>Finish: N/A Weight: N/A Quantity: N/A Scale: 1:2 @A4</p>	<p>Drawn By: SW Drawn Date: 30.06.15</p>
			<p>Drawing No: 402-ASS-004</p>		